

Redesigning Services for Older People and Parkhead Health & Social Care Centre

Ann Marie Rafferty
Head of Operations, North East Glasgow
2 November 2016

Redesigning Services for Older People

PRINCIPLES:

- Focussing on maintaining independence, health and wellbeing.
- Getting access to the right service at the right time.
- Working with communities, partners and staff to deliver initiatives that prevent ill health, intervene early, and avoid escalation of need.

CHALLENGES:

- High use of care home places
- Financial pressures across Health and Social Work

What are we doing?

- Developing G.P. Clusters
- Promoting neighbourhood approaches and developing neighbourhood teams
- Working with colleagues in Acute Services, to develop services that prevent unnecessary admissions to hospital and facilitate prompt discharge home.
- Developing Health and Social Care access hubs to provide a single point of contact to reduce duplication and improve efficiency.

Plans for New Health and Care Centre in Parkhead

- To replace existing Health Centre, Hospital and Mental Health Resource Centre
- Ideal location based near public transport links, shops and wide range of facilities
- Will support integrated working between Health and Social Work staff
- At early planning stage and local people will be involved as we develop our plans
- Cost of construction will be over £32m (twice as large as recent Health and Care Centres)
- Need to seek funding from Scottish Government (when this is announced)
- Will help reduce the costs of running older buildings in poorer condition

Potential Services at Parkhead Health and Social Care Centre

- 2 G.P. Surgeries
- Dental Services
- Community Pharmacy
- Primary Care Mental Health and Psychotherapy
- Rehabilitation and Enablement Services
- District Nursing
- Treatment Rooms
- Health Visiting and School Nursing
- Social Work Children and Family Teams
- Child and Adolescent Mental Health Services
- Community Paediatric (Children's) Services
- Older people's Mental Health services
- Learning Disability Services
- Physiotherapy and Podiatry Services
- Sandyford Sexual Health Services
- Health and Social Work Addiction Services
- Criminal Justice Social Work Services
- Social Work Training Centre
- Management and Administration functions
- Meeting and Seminar Rooms

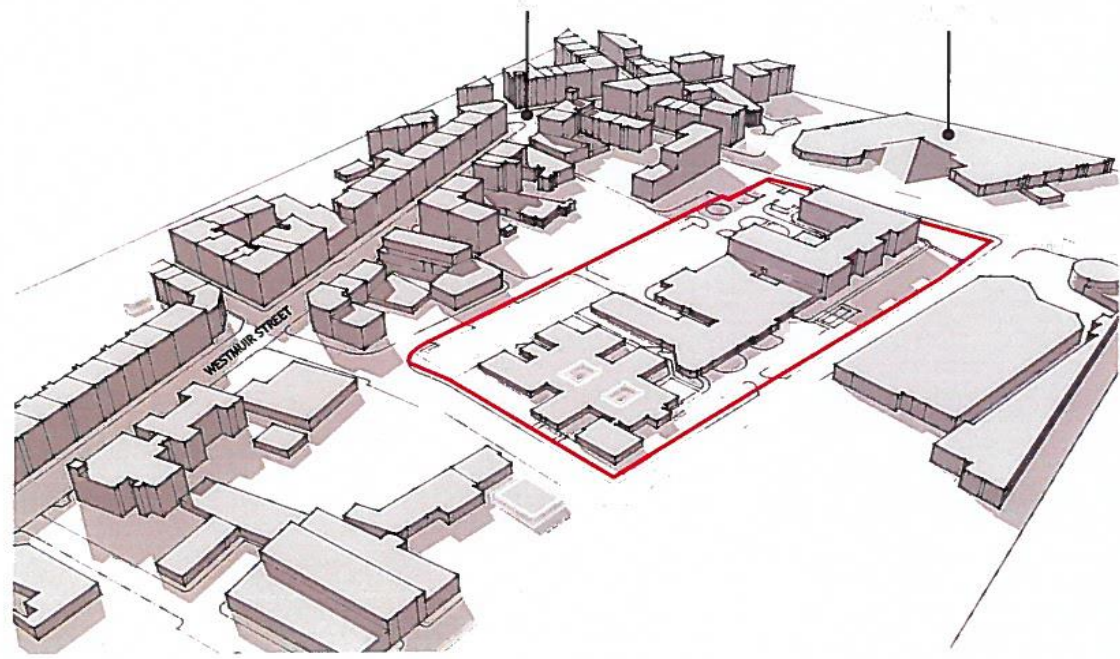

Existing Buildings

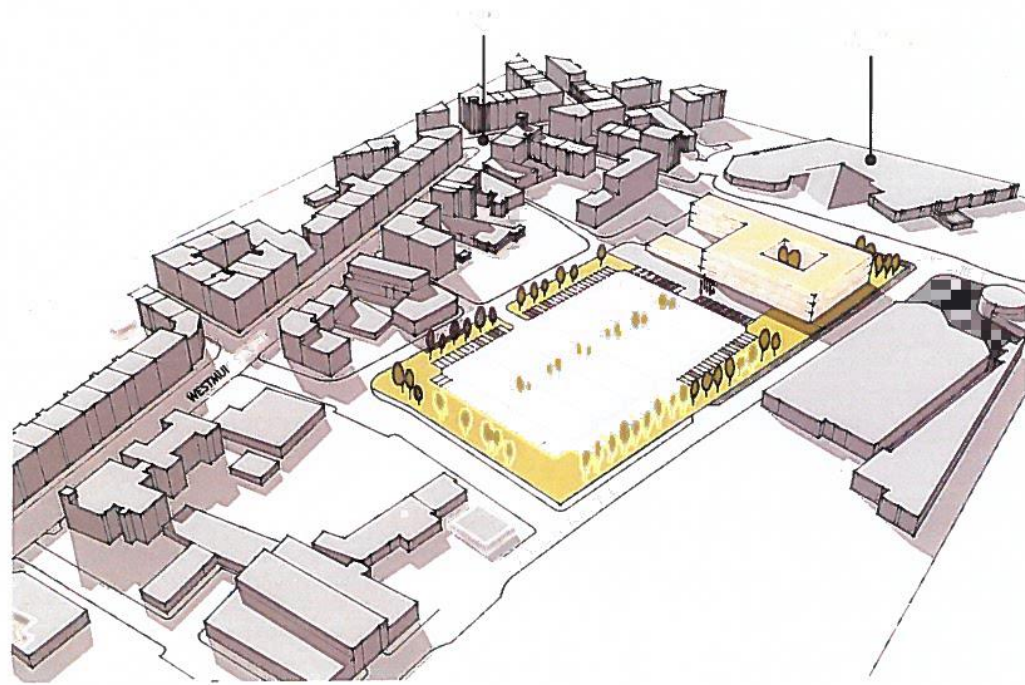

Possible future Health and Social Care Centre